

## S1312-ARMU/S1312-SBMU

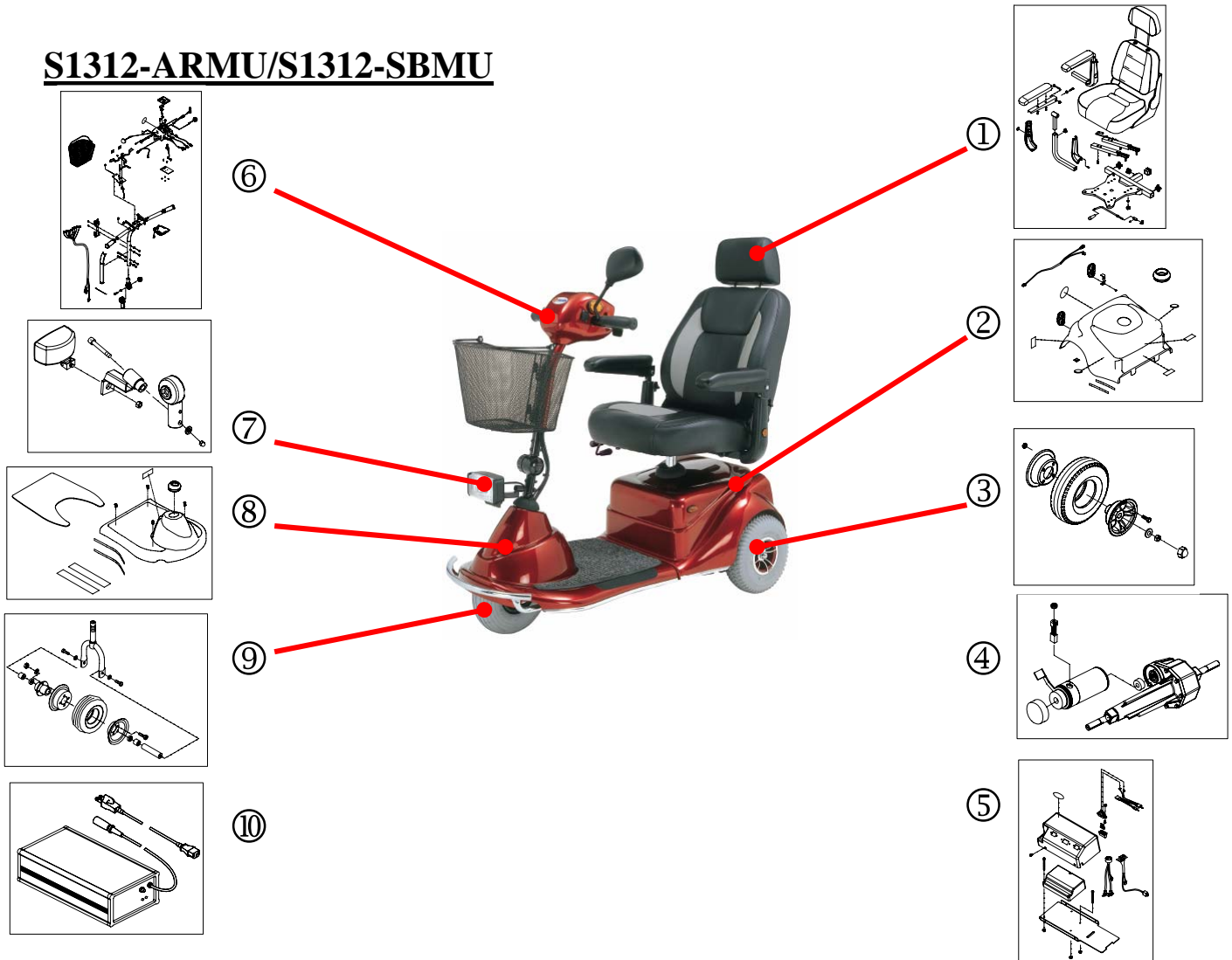

①	Seat ass'y	33510808 (TILLER ASS'Y., RED, S131)
	32200231(Captain Seat Only,20.5w*18d*20h,2 Tone)	33515807 (TILLER ASS'Y., BLUE,S131)
	43700401 (PAD, ARMREST)	⑦
②	Rear Shroud ass'y	Head Light Ass'y.
	30510434 (REAR SHROUD ASS'Y.,CANDY APPLE RED)	33710010(HEAD LIGHT ASS'Y)
	30515930 (REAR SHROUD ASS'Y.,METALLIC BLUE)	34203096(BRACKET,HEADLIGHT.)
③	Drive Wheel Ass'y	⑧
	32600045 (Rear Wheel Ass'y. 3.00-4c-248,Pu Tire,Red Rim)	Front Shroud ass'y
		30510874 (Front Shroud Set,Candyapple Red)
		30515971 (FRONT SHROUD ASS'Y,BLUE.)
④	Motor & Transmission.	⑨
	62001246 (TRANSAXLE ASS'Y., M407+M3HB-13)	Front Wheel Ass'y.
	62101212 (MOTOR SET (M3HB-13)	33100618 (Front Wheel Ass'y.,3.00-4, Pneumatic Tire)
	62201207 (TRANSAXLE, M407(2P)	⑩
⑤	Controller	Charger unit
	33703014 (CONTROLLER SET(OFF BOARD)	65142005 (CHARGER, HP8204-5A-OFF)
		63600008(CHARGER POWERCORD W/PLUG,US SPEC)